

16m Container Vehicle

Project: Proposed Temporary Vehicle Repair Workshop with Ancillary Facilities and Associated Filling of Land for a Period of 3 Years - Lot No. 317 in D.D.87 and adjoining Government Land, Kong Nga Po, Sheung Shui, New Territories

Legend:	Proposed Boundary Fencing	Parking Space (Private Car)
	Proposed Structure	Parking Space (HGV)
	L/UL Area (Container Vehicle)	

Figure:	SP-01
Scale:	1:400 @ A4
Drawing Date:	Jun 2026



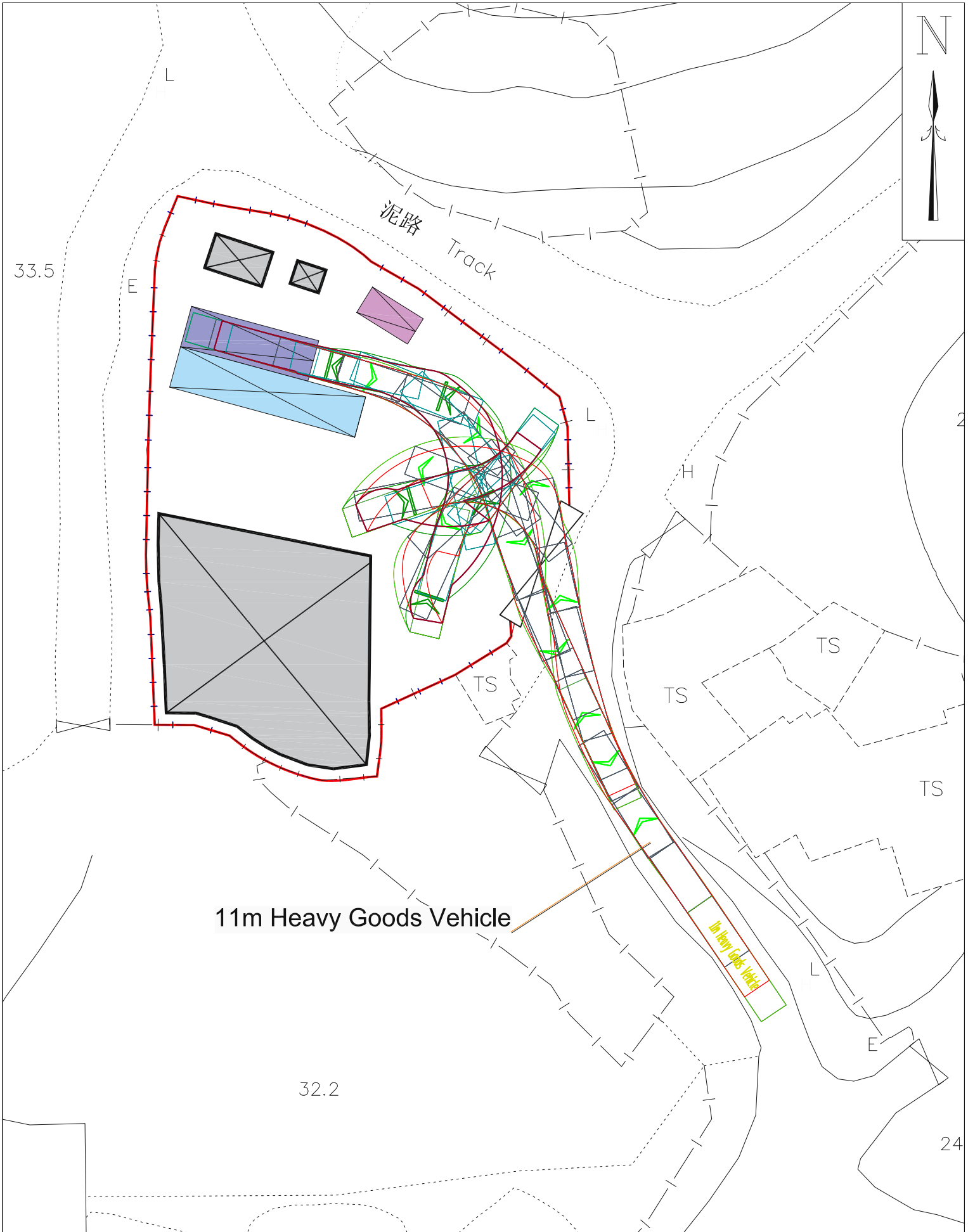

11m Heavy Goods Vehicle

11m Heavy Goods Vehicle

Project: Proposed Temporary Vehicle Repair Workshop with Ancillary Facilities and Associated Filling of Land for a Period of 3 Years - Lot No. 317 in D.D.87 and adjoining Government Land, Kong Nga Po, Sheung Shui, New Territories

<b>Legend:</b> Proposed Boundary Fencing Proposed Structure Parking Space (Private Car) Parking Space (HGV) L/UL Area (Container Vehicle)	Figure: SP-02
	Scale: 1:400 @ A4
	Drawing Date: Jun 2026



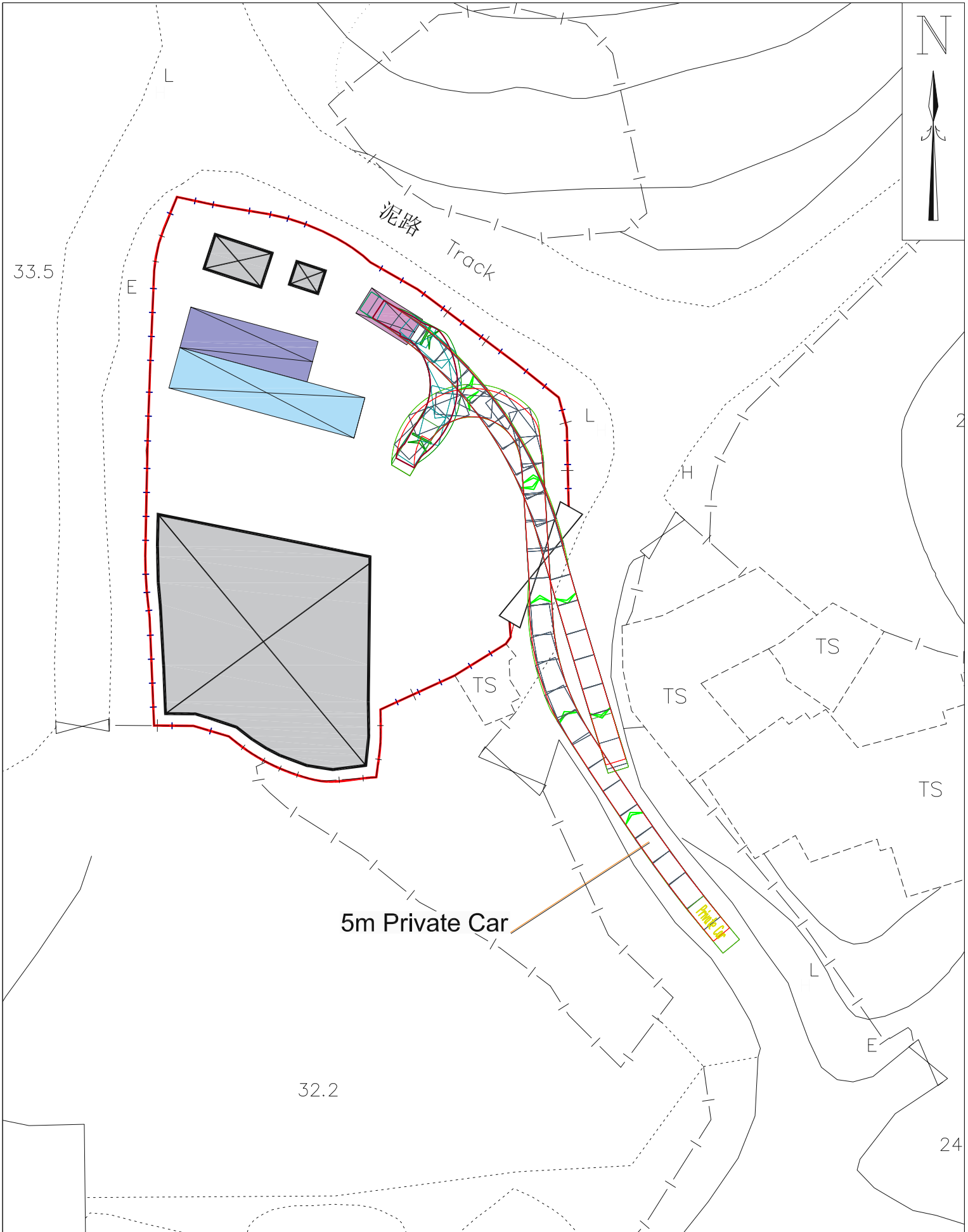

**Project:** Proposed Temporary Vehicle Repair Workshop with Ancillary Facilities and Associated Filling of Land for a Period of 3 Years - Lot No. 317 in D.D.87 and adjoining Government Land, Kong Nga Po, Sheung Shui, New Territories

<b>Legend:</b> Proposed Boundary Fencing Proposed Structure Parking Space (Private Car) Parking Space (HGV) L/UL Area (Container Vehicle)	<b>Figure:</b> SP-03
	<b>Scale:</b> 1:400 @ A4
	<b>Drawing Date:</b> Jun 2026

